

Illustrated Index

Torque Converter Housing/Valve Body

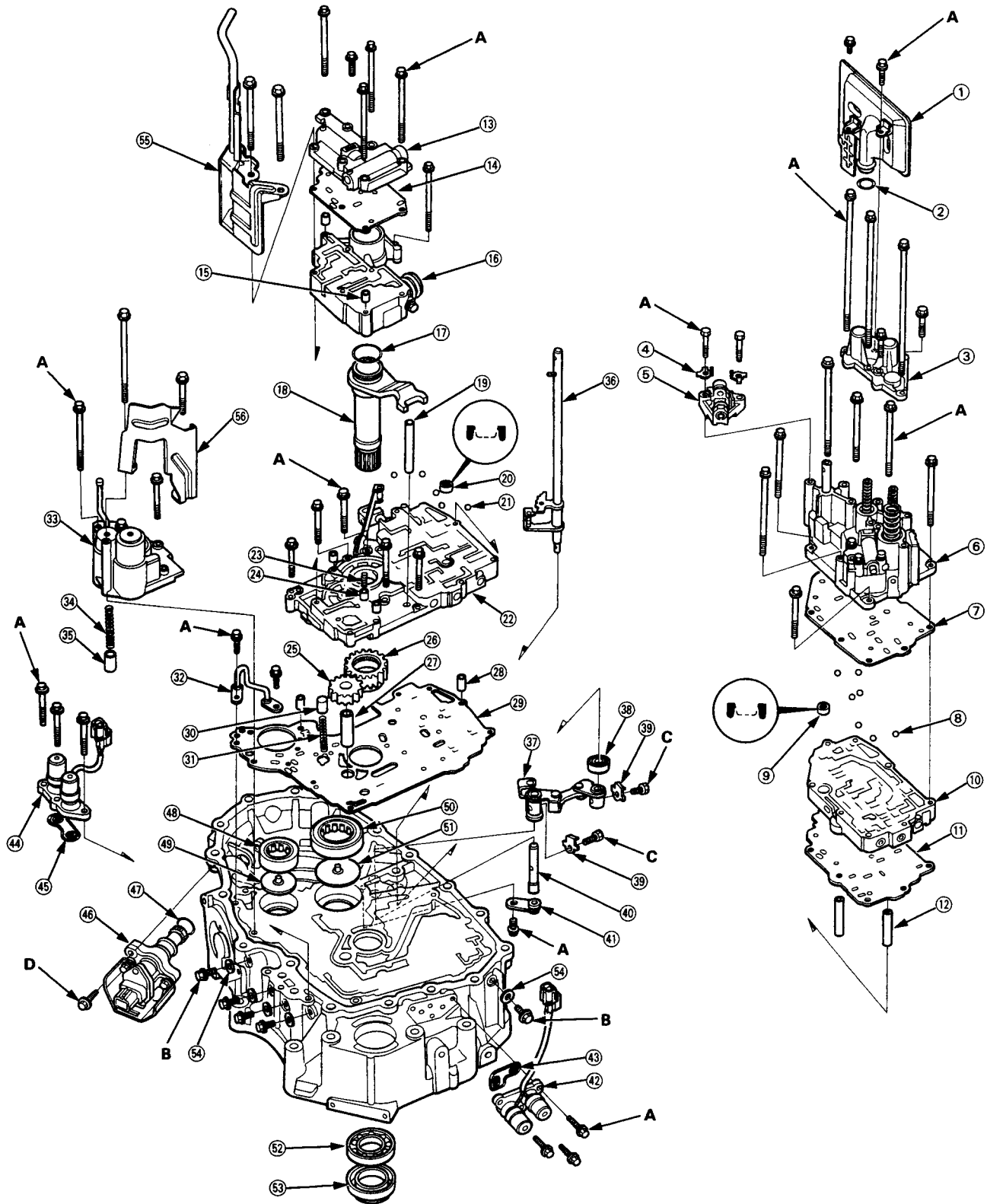



- | | |
|---|--|
| <ul style="list-style-type: none"> ① ATF STRAIER Clean or replace. ② O-RING Replace. ③ ACCUMULATOR COVER ④ LOCK WASHER Replace. ⑤ SERVO DETENT BASE ⑥ SERVO VALVE BODY ⑦ SERVO SEPARATOR PLATE ⑧ CHECK BALLS (7/32) #7 ⑨ SECONDARY VALVE BODY FILTER Replace. ⑩ SECONDARY VALVE BODY ⑪ SECONDARY SEPARATOR PLATE ⑫ DOWEL PIN ⑬ LOCK-UP VALVE BODY ⑭ LOCK-UP SEPARATOR PLATE ⑮ DOWEL PIN ⑯ REGULATOR VALVE BODY ⑰ O-RING Replace. ⑱ STATOR SHAFT ASSEMBLY ⑲ STOPPER PIN ⑳ MAIN VALVE BODY FILTER Replace. ㉑ CHECK BALLS (7/32) #7 ㉒ MAIN VALVE BODY ㉓ ONE-WAY RELIEF VALVE SPRING ㉔ ONE-WAY RELIEF VALVE ㉕ OIL PUMP DRIVEN GEAR ㉖ OIL PUMP DRIVE GEAR ㉗ OIL PUMP DRIVEN GEAR SHAFT ㉘ DOWEL PIN | <ul style="list-style-type: none"> ㉙ MAIN SEPARATOR PLATE ㉚ TORQUE CONVERTER CHECK VALVE ㉛ TORQUE CONVERTER CHECK VALVE SPRING ㉜ ATF LUBRICATION PIPE ㉝ 2ND ACCUMULATOR BODY ㉞ LSD RELIEF VALVE SPRING ㉟ LSD RELIEF VALVE ㊱ CONTROL SHAFT ㊲ CONTROL LEVER ㊳ OIL SEAL Replace. ㊴ LOCK WASHER Replace. ㊵ CHANGE SHAFT ㊶ CHANGE SHAFT CAP ㊷ SHIFT CONTROL SOLENOID VALVE ASSEMBLY ㊸ SHIFT CONTROL SOLENOID FILTER/GASKET Replace. ㊹ LOCK-UP CONTROL SOLENOID VALVE ASSEMBLY ㊺ LOCK-UP CONTROL SOLENOID FILTER/GASKET Replace. ㊻ VEHICLE SPEED SENSOR ASSEMBLY ㊼ O-RING Replace. ㊽ SECONDARY SHAFT NEEDLE BEARING Replace. ㊾ OIL GUIDE PLATE Replace. ㊿ COUNTERSHAFT NEEDLE BEARING Replace. ① OIL GUIDE PLATE Replace. ② MAINSHAFT BALL BEARING Replace. ③ MAINSHAFT OIL SEAL Replace. ④ SEALING WASHER Replace. ⑤ 4TH OIL GUIDE PLATE/PIPE ⑥ 3RD OIL GUIDE PLATE |
|---|--|

TORQUE SPECIFICATION

No.	TORQUE VALUE	BOLT SIZE	REMARKS
A	12 N·m (1.2 kg-m, 9 lb-ft)	6 x 1.0 mm	
B	18 N·m (1.8 kg-m, 13 lb-ft)	8 x 1.25 mm	OIL PRESSURE CHECK BOLT
C	14 N·m (1.4 kg-m, 10 lb-ft)	6 x 1.0 mm	Special bolt
D	30 N·m (3.0 kg-m, 22 lb-ft)	8 x 1.25 mm	