

# Illustrated Index

## Left Side Cover

---

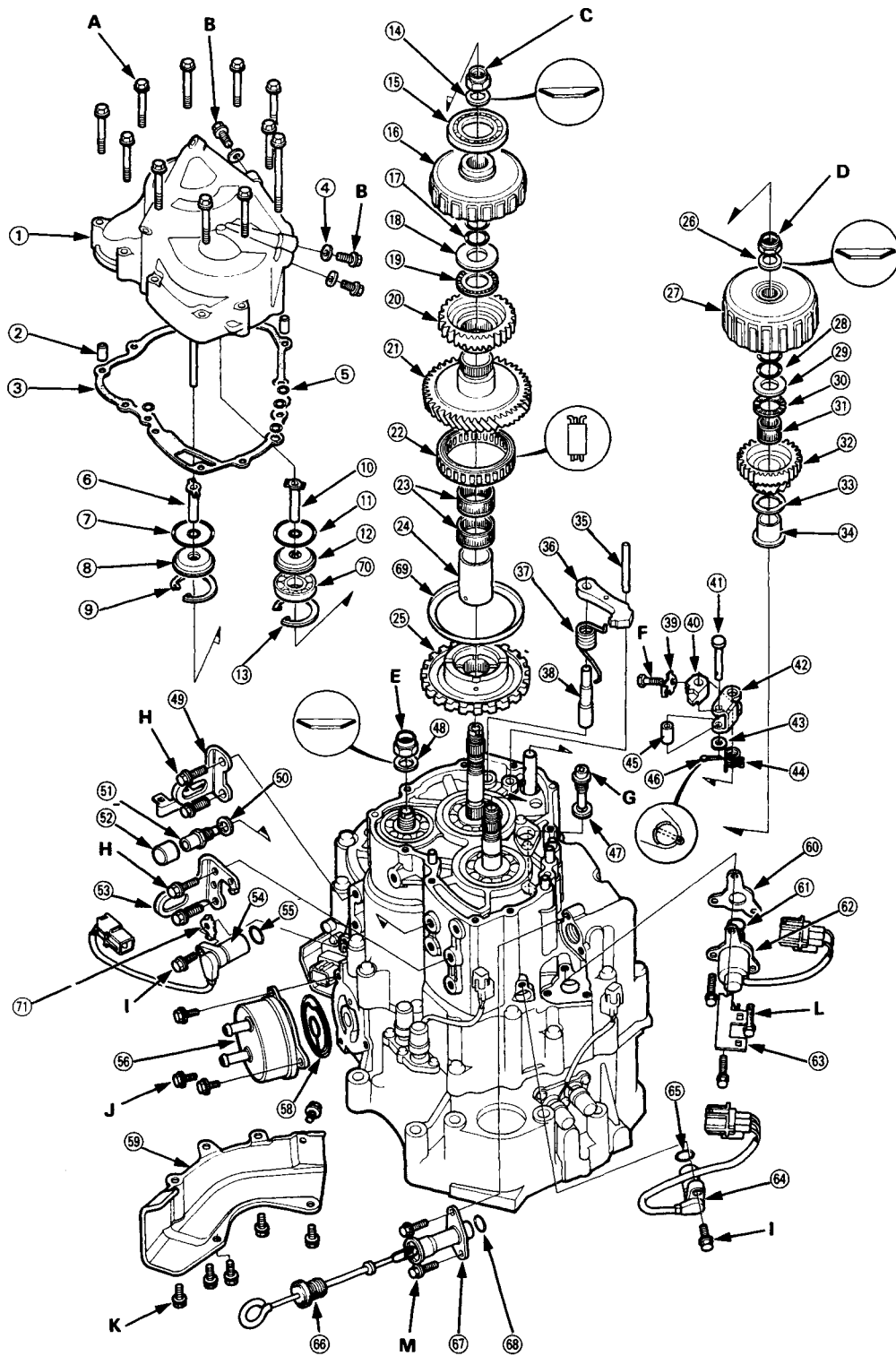



- |                                  |                                       |
|----------------------------------|---------------------------------------|
| ① LEFT SIDE COVER                | ③⑥ PARKING BRAKE PAWL                 |
| ② DOWEL PIN                      | ③⑦ PARKING BRAKE PAWL SPRING          |
| ③ GASKET Replace.                | ③⑧ PARKING BRAKE PAWL SHAFT           |
| ④ SEALING WASHER Replace.        | ③⑨ LOCK WASHER Replace.               |
| ⑤ O-RING Replace.                | ④① PARKING BRAKE STOPPER              |
| ⑥ 1ST-HOLD CLUTCH FEED PIPE      | ④② ROLLER PIN                         |
| ⑦ O-RING Replace.                | ④③ PARKING BRAKE LEVER                |
| ⑧ FEED PIPE FLANGE               | ④④ WASHER                             |
| ⑨ SNAP RING                      | ④⑤ PARKING BRAKE SPRING               |
| ⑩ 1ST CLUTCH FEED PIPE           | ④⑥ ROLLER                             |
| ⑪ O-RING Replace.                | ④⑦ COTTER PIN Replace.                |
| ⑫ FEED PIPE FLANGE               | ④⑧ SEALING WASHER Replace.            |
| ⑬ SNAP RING                      | ④⑨ CONICAL SPRING WASHER Replace.     |
| ⑭ CONICAL SPRING WASHER Replace. | ④⑩ TRANSMISSION HANGER/CONNECTOR STAY |
| ⑮ BALL BEARING                   | ⑤① SEALING WASHER Replace.            |
| ⑯ 1ST-HOLD CLUTCH ASSEMBLY       | ⑤② BREATHER JOINT                     |
| ⑰ O-RING Replace.                | ⑤③ BREATHER CAP                       |
| ⑱ THRUST WASHER                  | ⑤④ TRANSMISSION HANGER                |
| ⑲ THRUST NEEDLE BEARING          | ⑤⑤ COUNTERSHAFT SPEED SENSOR          |
| ⑳ 1ST-HOLD CLUTCH HUB            | ⑤⑥ O-RING Replace.                    |
| ㉑ COUNTERSHAFT 1ST GEAR          | ⑤⑦ ATF COOLER                         |
| ㉒ ONE-WAY CLUTCH                 | ⑤⑧ ATF COOLER FILTER/GASKET Replace.  |
| ㉓ NEEDLE BEARINGS                | ⑤⑨ SPEED SENSOR COVER                 |
| ㉔ COUNTERSHAFT 1ST GEAR COLLAR   | ⑥① LINEAR SOLENOID SHIM               |
| ㉕ PARKING GEAR                   | ⑥② O-RING Replace.                    |
| ㉖ CONICAL SPRING WASHER Replace. | ⑥③ LINEAR SOLENOID                    |
| ㉗ 1ST CLUTCH ASSEMBLY            | ⑥④ CONNECTOR STAY                     |
| ㉘ O-RING Replace.                | ⑥⑤ MAINSHAFT SPEED SENSOR             |
| ㉙ THRUST WASHER                  | ⑥⑥ O-RING Replace.                    |
| ㉚ THRUST NEEDLE BEARING          | ⑥⑦ ATF LEVEL GAUGE                    |
| ㉛ NEEDLE BEARING                 | ⑥⑧ ATF LEVEL GAUGE PIPE               |
| ㉜ MAINSHAFT 1ST GEAR             | ⑥⑨ O-RING Replace.                    |
| ㉝ THRUST WASHER                  | ⑦① RETAINER PLATE                     |
| ㉞ MAINSHAFT 1ST GEAR COLLAR      | ⑦② BALL BEARING                       |
| ㉟ PARKING BRAKE PAWL STOPPER     | ⑦③ COUNTERSHAFT SPEED SENSOR WASHER   |

#### TORQUE SPECIFICATION

No.	TORQUE VALUE	BOLT SIZE	REMARKS
A	12 N·m (1.2 kg-m, 9 lb-ft)	6 x 1.0 mm	
B	18 N·m (1.8 kg-m, 13 lb-ft)	8 x 1.25 mm	OIL PRESSURE CHECK BOLT
C	140 N·m (14.0 kg-m, 101 lb-ft)	24 x 1.25 mm	COUNTERSHAFT LOCKNUT (Left-hand threads) Replace.
D	140 N·m (14.0 kg-m, 101 lb-ft)	23 x 1.25 mm	MAINSHAFT LOCKNUT Replace.
E	140 N·m (14.0 kg-m, 101 lb-ft)	24 x 1.25 mm	SECONDARY SHAFT LOCKNUT Replace.
F	14 N·m (1.4 kg-m, 10 lb-ft)	6 x 1.0 mm	Special bolt (Replace.)
G	50 N·m (5.0 kg-m, 36 lb-ft)	18 x 1.5 mm	DRAIN PLUG
H	30 N·m (3.0 kg-m, 22 lb-ft)	8 x 1.25 mm	
I	12 N·m (1.2 kg-m, 9 lb-ft)	6 x 1.0 mm	
J	30 N·m (3.0 kg-m, 22 lb-ft)	8 x 1.25 mm	ATF COOLER BOLT
K	12 N·m (1.2 kg-m, 9 lb-ft)	6 x 1.0 mm	
L	10 N·m (1.0 kg-m, 7 lb-ft)	6 x 1.0 mm	LINEAR SOLENOID BOLT
M	12 N·m (1.2 kg-m, 9 lb-ft)	6 x 1.0 mm	